

SPINNAKER

*Fleuss*  
CHRONOGRAPH  
SPONGEBOB  
SQUAREPANTS  
EVE DIAL  
LIMITED EDITION  
**MECA-QUARTZ  
CHRONOGRAPH**

This timepiece is powered by a Japanese made "Meca-Quartz" movement.

It combines a battery regulated engine with a mechanical chronograph module.

The result is a watch which delivers the meticulous pinpoint precision of a quartz movement along with the crisp, flyback handfeel and visual charm of mechanical watches.

For more details on operating this timepiece please refer to the enclosed booklet or visit:

**spinnaker-watches.com**

SPINNAKER

*Fleuss*  
CHRONOGRAPH  
SPONGEBOB  
SQUAREPANTS  
EVE DIAL  
LIMITED EDITION

**Instruction Manual**



For more information  
Pour plus d'informations  
Para más información  
Per maggiori informazioni  
Für mehr Informationen  
想要查询更多资讯  
詳細については

Vol. 1.154\_SB EN

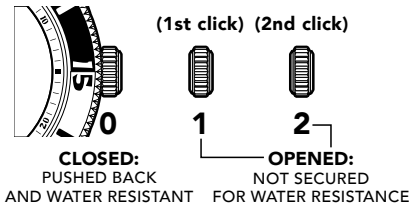
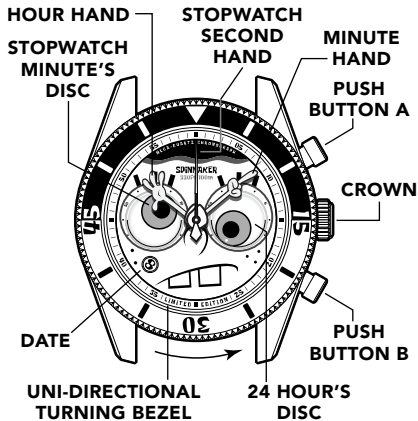

## HOW TO SET THE TIME

1. Pull the crown to position [2]-(2nd click).
2. Turn the crown clockwise to set the correct time.
3. Push the crown in.

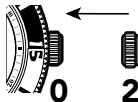
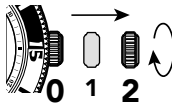

- \* Take A.M./P.M. into consideration when setting the hour and minute hands to the desired time.
- \* When the crown is at the position [2 ], do not press any button, otherwise the chronograph hands will move.

## HOW TO SET THE DATE

1. Pull the crown out to position [1]-(1st click).
2. Turn the crown clockwise to set the correct date.
3. Push the crown in.

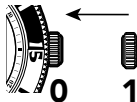
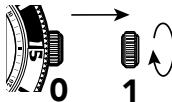

## STOPWATCH FUNCTION

- \* Do not set the date between 9:00 P.M. and 3:00 A.M., otherwise the day may not change properly. If it is necessary to set the date during the time period, first change the time to any time outside it, set the date and then reset the correct time.

- The stopwatch can measure up to 60 minutes.

### STANDARD MEASUREMENT

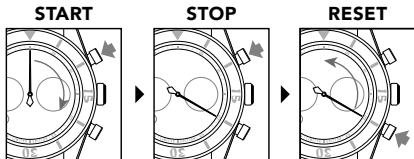

## ACCUMULATED ELAPSED TIME MEASUREMENT

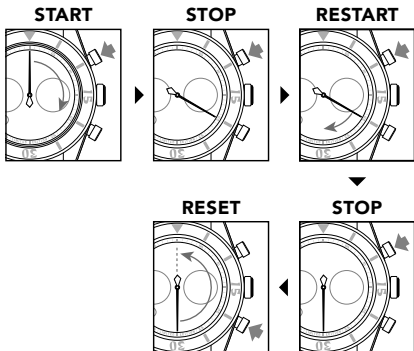

\* Restart and stop of the stopwatch can be repeated by pressing the button A.

## WATER RESISTANCE

Note that the water resistance chart serves only as a guide (please refer to the water resistance chart on the next page). Actual water resistance may vary depending on a number of factors including water temperature, water salinity and use under water.

The water resistance of your timepiece may eventually be compromised over time with general wear and tear and use of your timepiece under adverse conditions.

Always remember to employ the screw down crown if available to maintain the water resistance of your timepiece. Warranty may be voided if the screw down crown has not been properly employed.

Note that you should NEVER wear your watch in a jacuzzi, hot shower or steam room where steam may enter the case despite the watertight seals used to protect your watch.

This may cause condensation inside your watch, which may affect and damage the inner workings of your watch.

WATER RESISTANCE CHART	50M/ 5ATM	100M/ 10ATM	200M/ 20ATM	300M/ 30ATM	500M/ 50ATM
SPLASH/ SHOWERING					
SWIMMING/ BATHING					
BRIEF SWIMMING/ WATER SPORTS					
PROLONGED SWIMMING/ FREE DIVING					
SCUBA DIVING					
PROFESSIONAL DEEP SEA DIVING					

## **Represented By: (for EU/UK)**

Authorised Rep Compliance Ltd.,  
Ground Floor, 71 Lower Baggot Street,  
Dublin, D02 P593, Ireland.



## **WARNING**

- **INGESTION HAZARD:** This product contains a button cell or coin battery.
- **DEATH** or serious injury can occur if ingested.
- A swallowed button cell or coin battery can cause **Internal Chemical Burns** in as little as **2 hours**.
- **KEEP** new and used batteries **OUT OF REACH of CHILDREN**.
- **Seek immediate medical attention** if a battery is suspected to be swallowed or inserted inside any part of the body.



- Remove and immediately recycle or dispose of used batteries according to local regulations and keep away from children. Do NOT dispose of batteries in household trash or incinerate.
- Even used batteries may cause severe injury or death.
- Call a local poison control center for treatment information.
- Battery Voltage: 1.55V
- Non-rechargeable batteries are not to be recharged.
- Do not force discharge, recharge, disassemble, heat above 140°F / 60°C or incinerate. Doing so may result in injury due to venting, leakage or explosion resulting in chemical burns.
- Ensure the batteries are installed correctly according to polarity (+ and -).
- Do not mix old and new batteries, different brands or types of batteries, such as alkaline, carbon-zinc, or rechargeable batteries.
- Remove and immediately recycle or dispose of batteries from equipment not used for an extended period of time according to local regulations.
- Always completely secure the battery compartment. If the battery compartment does not close securely, stop using the product, remove the batteries, and keep them away from children.